



## Activities Directory

*Kings Point has the most extensive amenities of any active adult community in the region.  
We offer a stunning variety of amenities to fit your lifestyle.*

*Updated: 3/01/2024*



### **Kings Point North Club**

1900 Clubhouse Drive, Sun City Center, FL 33573

813-387-3439

### **Kings Point South Club**

1224 Newpoint Loop, Sun City Center, FL 33573

813-387-3449

### **Cyber Space**

1000 Kings Blvd., Sun City Center FL 33573

813-540-5450

### **2020 Centre**

2020 Clubhouse Drive, Sun City Center, FL 33573

813-387-3458

### **Serenity Spa & Salon**

2020 Centre, Sun City Center, FL 33573

813-387-3475

### **Kings Point Community Pool**

1575 Nantucket Drive, Sun City Center, FL 33573

813-633-3551

# Kings Point Activity Catalog

*Prepared for you by Vesta Property Management*

**All activity information was current as of 3/1/2024.** Activities are year round unless otherwise noted.

Activity presidents may submit changes in writing to the Vesta Business Office or by email to Nanette Leggett at [NLeggett@vestapropertyservices.com](mailto:NLeggett@vestapropertyservices.com) for the next printing.

## Table of Contents

<b>Amenities</b> Clubs - Main, South, 2020 Centre, Cyber Space Dining - Le Perk Café, Palm Court Café Bar and Restaurant	<b>3-7</b>
<b>Billiards</b>	<b>5</b>
<b>Cards</b> - Bridge, Cribbage, Euchre, Hand & Foot, and Pinochle	<b>6-7</b>
<b>Creative Arts</b> - Acrylic Painting, Art Multimedia, Bunka, Ceramics, Colored Pencil, Glass Arts, Krafters, Lapidary Cabbing, Chain Maille, Faceting, Gem Trees, Jewelry Making/Beading; Kumihimo, Wire Wrapping, Embroidery, Paper Tole, Pottery, Shell Art, Quilting, Rubber Stampers, Watercolor, and Woodshop	<b>7-13</b>
<b>Dance</b> - Country Western, Hawaiian, Silver Shakers/Belly Dancing and Tappers	<b>14</b>
<b>Fitness</b> - Aerobics, Chair Tai Chi, Water and Land Group Fitness (Please check The Pointer for classes, dates, room and times)	<b>15-19</b>
<b>Gaming</b> - Bingo	<b>20</b>
<b>Indoor Sports</b> - Bowling-offsite and Table Tennis	<b>20</b>
<b>Music</b> - Chorus (Mixed Group), Performing Arts-Pelican Players, Ukulele Players Group	<b>20</b>
<b>Outdoor Sports</b> - Archery, Bocce, Cornhole, Pickleball, Lawn Bowling, Shuffleboard, Softball, Tennis, and Volleyball	<b>21-22</b>
<b>Parlor Games</b> - Bunco, Chess, Dominoes (Mexican Train), Mah Jongg, Rummikub, Scrabble	<b>23</b>
<b>Services</b> - AARP Driver Safety Program, COA Mtgs, Federation Board & Membership Mtgs, Master Association Board Mtgs, Sun City Center Emergency Squad, and Jen's Open Air Market	<b>23-24</b>
<b>Clubs &amp; Organizations</b> - Amateur Radio, Apple Club, Baby Boomer, Canadian, Come Dance With Us, Discussion Grp, Dog Lovers, Economic Education, Feline Folks, Garden, Healthy Lifestyles, Heartland, Italian, KP Dance Club, Michigan, Mix & Mingle, Railroad, New England, New York, Photography, Ohio, Rockin' Thru the Yrs, Sportsman, TOPS, and Wisconsin.	<b>24-27</b>



## Hours of Operation

---

### **Kings Point Clubhouse Main (KPCH) 1900 Clubhouse Drive 813-634-9229**

Clubhouse	Monday - Sunday	8:00 a.m.	10:00 p.m.
Box Office	Monday - Friday	8:30 a.m.	4:00 p.m.
Business Office	Monday - Friday	8:30 a.m.	4:30 p.m.
Le Perk Café	Monday - Friday	8:00 a.m.	2:00 p.m.
<b>*Indoor Pool</b>	Daily	7:00 a.m.	9:30 p.m.
	Children (7 days a week)	12:00 p.m.	2:00 p.m.
	Children Hours (Nightly)	7:00 p.m.	9:00 p.m.
<b>*Lap Swimming</b>	Tuesday - Wednesday - Thursday	4:00 p.m.	5:00 p.m.
	Saturday - Sunday	8:30 a.m.	9:30 a.m.
<b>*Hot Tub</b>	Daily (Adults Only)	7:00 a.m.	9:30 p.m.
<b>*Outdoor Pool</b>	Daily	7:00 a.m.	9:30 p.m.
	Children allowed daily at the Outdoor Pool	(Regular Pool hours)	

### **2020 Centre 2020 Clubhouse Drive 813-387-3458**

Clubhouse/Fitness Centre	Monday - Friday	6:30 a.m.	8:00 p.m.
	Saturday-Sunday	7:00 a.m.	5:00 p.m.
Serenity Spa & Salon	Monday - Friday	9:00 a.m.	4:00 p.m.

### **Kings Point South Club (KPSC) 1224 Newpoint Loop 813-387-3449**

Clubhouse	Monday - Sunday	7:00 a.m.	9:30 p.m.
Business Office	Monday - Friday	7:00 a.m.	3:00 p.m.
Fitness Center	Monday - Friday	6:30 a.m.	9:30 p.m.
	Saturday & Sunday	7:00 a.m.	9:30 p.m.
Palm Court Café	Thursday - Sunday	8:00 a.m.	8:00 p.m.
	Monday - Wednesday	11:00 a.m.	8:00 p.m.
Palm Court Bar	Monday - Sunday	11:00 a.m.	10:00 p.m.
Pool Patio Bar	Saturday & Sunday	12:00 p.m.	4:00 p.m.
Pools - Indoor & Outdoor	Monday - Sunday	7:00 a.m.	9:30 p.m.
	Children allowed daily at Outdoor Pool	(Regular Pool Hours)	
Hot Tub	Daily (Adults Only)	7:00 a.m.	9:30 p.m.

### **Cyber Space (Falcon Watch) 1000 Kings Blvd 813-540-5450**

Cyber Space	Monday - Saturday	8:00 a.m.	2:00 p.m.
-------------	-------------------	-----------	-----------

### **Kings Point Community Outdoor Pool & Hot Tub 1575 Nantucket Drive**

Nantucket Pool	Daily	7:00 a.m.	Dusk
Hot Tub	Daily (Adults Only)	7:00 a.m.	Dusk

***\*Please note: All pools will be closed for the safety of our residents and guests during inclement weather.***

## Amenities

### Cyber Space

Monday - Saturday 8:00 AM 2:00 PM

Direct Phone 813-540-5450

Connect to the world wide web with high speed Internet. Use the fully equipped Business Center with the convenience of faxing / printing. Notary services available Monday - Thursday 8 am to 1pm.

### Fitness Centers

Fitness Director Jennifer Yurcus 813-387-3476

2020 Centre Mon—Fri 6:30 AM 8:00 PM Sat-Sun 7:00 AM 5:00 PM

KPSC Mon—Sun 7:00 AM 9:00 PM

Health and wellness club designed to meet your fitness needs. The Energy Studio and the Balance Studio offer a variety of exercise classes to meet all levels of fitness. Take your cardiovascular and weight workouts to the next level with state of the art fitness equipment guided by trained staff.

### Library - Main Clubhouse

813-634-2377

Sunday - Saturday 8:00 AM 10:00 PM

Ginny Defever 813-634-6686 KPCH Library

The Kings Point Library is available to residents. Reading promotes lifelong learning and enhanced quality of life. Volunteers are on duty in the morning from 9:00am - 11:00 a.m. and in the afternoon from 1-3 p.m. to assist you. Residents may check out books, CDs and cassettes on the honor system.

### Serenity Spa & Salon

Monday - Friday 9:00 AM 4:00 PM

Robin Razick 813-387-3475 2020 Centre Spa Serenity

Kings Point residents and guests can enjoy a full service spa close to home with great prices. Make an appointment at Serenity Spa and Salon for massage, facials, pedicures, manicures, waxing, hair styling or barber services. Gift certificates, spa parties and packages (upon availability) .

### Vehicle Storage

Master Association

Dave Wetmore-President 813-938-1877

Jerry Stanford 813-731-0283 KPYARMASTER@gmail.com KPVSclub@gmail.com

The storage facility is conveniently located securely on Kings Point property. Kings Point residents call for a quote and reserve your space on the waiting list to store cars, RV, boats and trailers. No commercial vehicles. All must have wheels. November membership meeting.

## Amenities - Dining

### Le Perk Café - KPCH

Monday—Friday

8:00 AM 2:00 PM

Le Perk Café features breakfast sandwiches, deli sandwiches, soup of the day, salads, hot dogs, ice cream, cookies, muffins, soda, coffee and tea.

## Amenities - Dining Continued....

<b>Palm Court Bar-South Club</b>	Monday—Sunday	11:00 AM	10:00 PM
<b>Palm Court Cafe</b>	Monday—Wednesday	11:00 AM	8:00 PM
	Thursday—Sunday	8:00 AM	8:00 PM
		No Breakfast	Breakfast served 8 AM-11AM

Palm Court Take Out Orders      813-387-3483   11am - 8pm

Palm Court is your “Cheers” with fresh made to order pizzas, wings, burgers, soups, salads, sandwiches and full bar service. TV's, Direct TV NFL and a fun atmosphere. Now offering breakfast Thursday - Sunday 8 am -11:00 am.

---

<b>Poolside Bar - South Club</b>	Saturday & Sunday	12:00 PM	4:00 PM
----------------------------------	-------------------	----------	---------

Join us on Friday, Saturday, and Sunday for resort style living. Poolside cookout specials and tropical drinks with a full-service bar and fun music. *\*Please note: All pools will be closed for the safety of our residents and guests during inclement weather.*

---

## Billiards

<b>Billiard Club - Open Play, Game of Choice</b>	Daily	8:00 AM	9:30 PM
Alan Hahn	847-561-6075	KPCH	Billiard Room

Come play pool with friends and meet new people. The Billiard room is open all day everyday for your pool playing pleasure. Come with a friend, or get into one of the pickup games going on. The best times to find an open table are weekends and Monday-Friday before 11am or after 4pm.

---

## Cards

<b>Bridge (Casual Open)</b>	Friday	1:00 PM	3:00 PM
Linda Argersinger                      813-812-7191	KPCH	East Social Rm.	

Bridge is played with four people at a card table using a standard deck of 52 cards. Join residents for a casual, fun game of bridge. No partner necessary.

---

<b>Bridge, (Duplicate ACBL Sanctioned)</b>	Tuesday & Wednesday	1:00 PM	4:30 PM
Tom Richard 813-431-0823                      Gerry Richards 813-431-0824	KPCH	Card Room	

Tuesday's 0-199 Masterpoints and Wednesday's 0-999 Masterpoints. Registration opens at 12 P.M. Cost \$3.00 entry fee.

---

<b>Bridge (Party)</b>	Tuesday & Friday	12:00 PM	3:00 PM
Tom and Kathy Sullivan                      813-331-3176	2020 Centre	Culinary Room	

Bridge is played with four people at a card table using a standard deck of 52 cards. Join residents for a casual fun game of bridge. No partner necessary, but some experience is preferred. Tables rotate partners. Game starts promptly at noon. Please arrive 10 minutes early. No reservation required.

---

<b>Bridge (Social Duplicate)</b>	Wed.	6:15 PM	9:30 PM
Patti Watts                      989-295-4449	KPCH	East Social Room	

We play for fun, not for master points. Call Patti if interested in joining us. Welcome.

---

<b>Bunco Monthly Pot Luck Dinner</b>	1st Saturday Starting October—June 2024	5:00 PM	9:00 PM
Mary Ann Dayton                      813-401-9984	KPCH	Waterside Room	

Food, laughter, dice and fun! Bring a dish to share and join in a fun evening! Off July, August, September

---

<b>Cribbage (Playing)</b>	Monday	6:00 PM	8:00 PM
Terri Nowacki                      813-922-4980	KPCH	East Social Room	

All are welcome to join our cribbage game! Cribbage is a card game which involves grouping cards in combinations to gain points. Scoring is kept on a cribbage board. \$1.00 donation for supplies.

---

<b>Cribbage (Playing)</b>	Thursday	6:00 PM	8:00 PM
Ron Ruhle                      719-291-1245	KPCH	East Social Room	

Cribbage is a card game which involves grouping cards in combinations to gain points. Scoring is kept on a cribbage board. Join residents for a game of Cribbage. \$1.00 donation for supplies.

---

## Cards Continued....

<b>Euchre Club</b>		Tuesday	6:30 P.M.	9:00 P.M.
Tom Jones	614-214-1499	KPCH	Card Room	
Carl Wink	605-593-1383			

Euchre is a card game played with the twenty-four highest cards. The aim is to win three of the five tricks played. No partners are necessary we rotate tables and players. Cost \$1.00 per player.

<b>Pinochle (Double/Triple Deck) *RESIDENTS ONLY*</b>		Wednesday	1:00 PM	4:00 PM
Bonnie DeVagno	813-260-3956	Starting Oct—Thursday	10:00 AM	12:00 PM
Nina Partin	813-508-6462	KPSC	Game Room	

Pinochle players score points by trick-taking and also by forming combinations of cards into melds. Each hand is played in three phases: bidding, melds, and tricks. Experienced players w/ double deck, social play. Thursday is learn to play.

<b>Pinochle (Just for Fun)</b>		Monday	6:00 PM	8:30 PM
Roberta Rowe	813-215-7127	KPCH	Card Room	

Pinochle for fun. Pinochle players score points by trick-taking and also by forming combinations of cards into melds. Each hand is played in three phases: bidding, melds, and tricks. Cost \$1.00 per player.

<b>Pinochle (Just for Fun)</b>		Wednesday & Friday	6:30 PM	9:30 PM
George & Judy Fenwick	813-634-5364	KPCH	Card Room	

Pinochle for fun. Pinochle players score points by trick-taking and also by forming combinations of cards into melds. Each hand is played in three phases: bidding, melds, and tricks. Eight Tables Cost \$0.50 per player for prizes. Optional extra \$.25 for high game. Set up at 6:15 p.m.

## Creative Arts

<b>Acrylic Painting Workshop Group</b>	Tuesday	1:00 pm	4:00 pm
Jane Sturmer	715-923-2393	KPCH	Art Room

Learn new skills and techniques. Fun class for anyone who wants to explore their creative side. Bring a canvas. Paints and brushes will be available. 20 people maximum.

<b>Art Multimedia Open Studio</b>	Thurs, Wed & Fri.	9:00 AM	12:00 PM
	KPCH	Art Room	

Room Monitors: Phyllis Masing and Sandy Greco

Join fellow artists while exploring your own artist endeavors. Use your favorite medium.

# Kings Point Clubhouse



1900 Clubhouse Drive

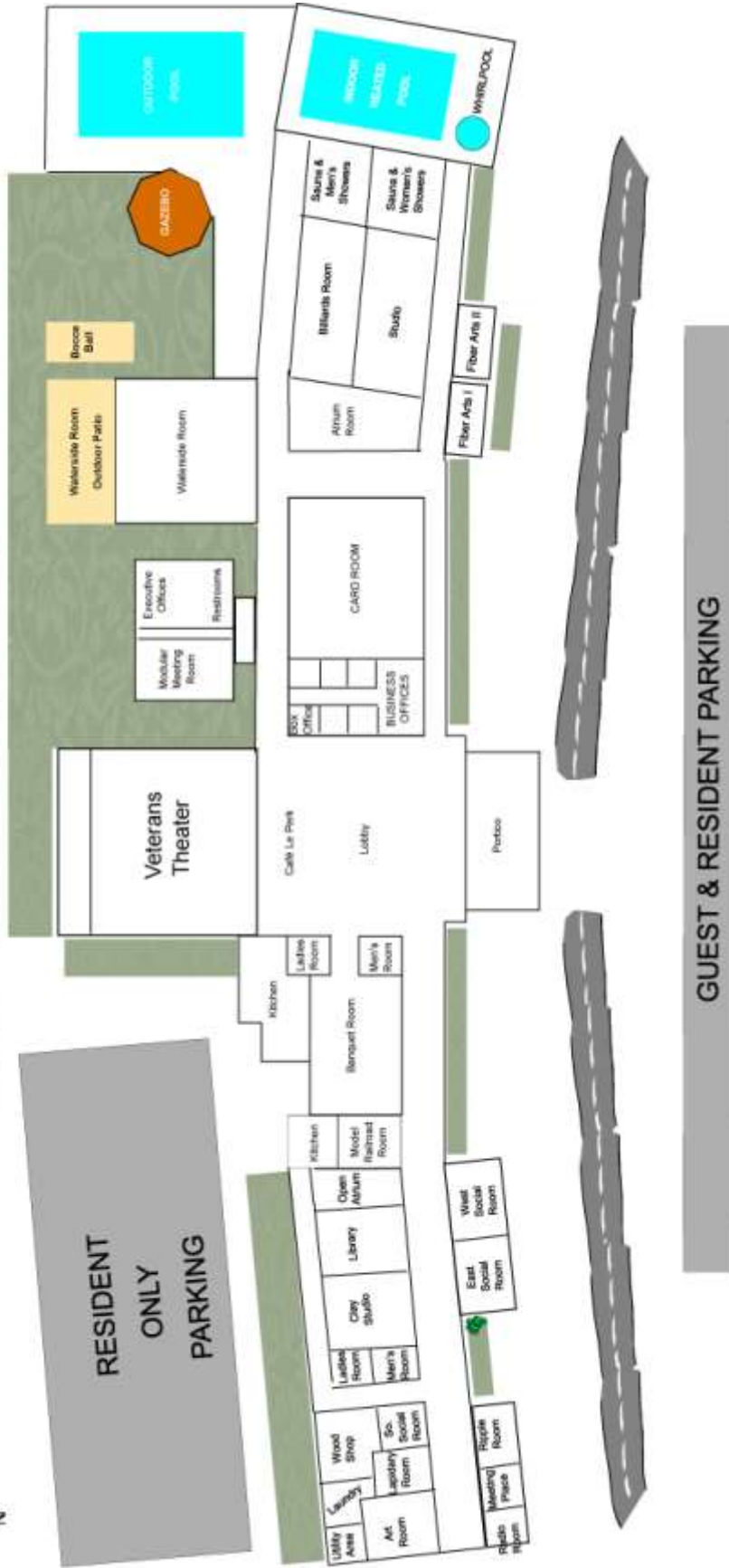

Kings Point Blvd.

Sun City Center Blvd.



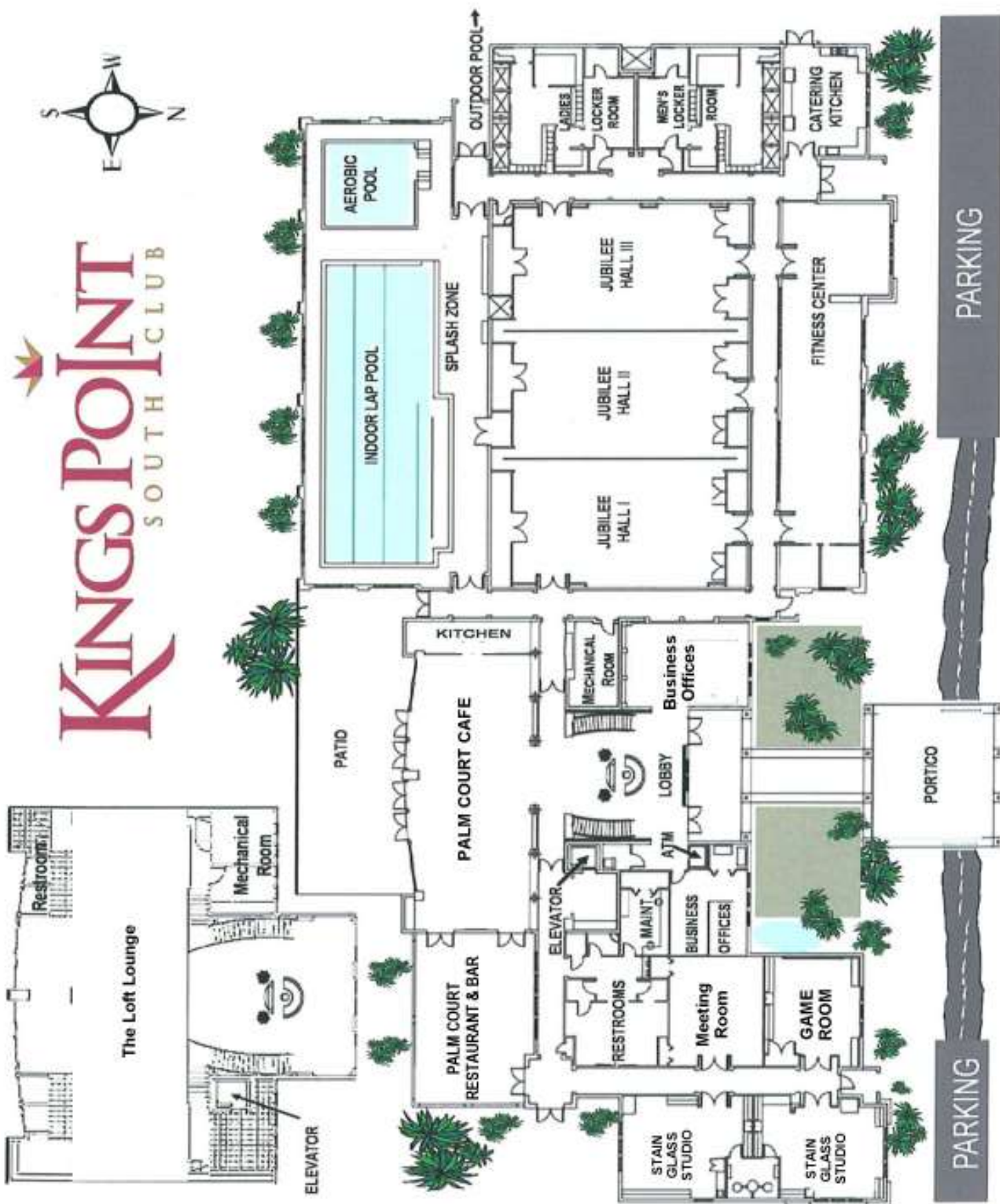

## Creative Arts Continued....

## Bunka - Japanese Embroidery

Anise Tuma

813-633-0499

Tuesday

KPCH

11:00 AM 4:00 PM

Fiber Arts Room II

Enjoy the classic art of Japanese Embroidery art called Bunka Shishu with friends. No Dues.

## Ceramics Club of Kings Point

Lonnie Eaker

813-395-2412

Thursday

KPCH

9:00 AM      3:00 PM

## Clay Studio

Learn how to make products from clay or similar materials treated by firing. Instruction includes; cleaning green ware, using stains, glazes and special products. Supplies may be purchased in class. Voluntary fee of \$1.00 for instructor.

## Glass Arts Club

Sandy Ford

941-324-8221

## Kings Point South Club Hours of Operation

KPSC

## Glass Arts Studio

Club members explore their creative side by making decorative glass pieces including sun catchers, lights and lamps, panels, plates, sculptures, and more from fused and stained glass techniques. Studio is open during club house hours. Contact Paula for more information.

## Krafters

Susan Edgerton

303-653-8114

Wednesday

KPCH

9:00 AM      12:00 PM

## Fiber Arts Room

Ladies, join us to share techniques and tips for: crochet, knitting and canvas. Bring a project or learn to create something new. No membership dues or supply cost. All projects are sold and money is donated to Sun City Center charities.

**Lapidary Club — Full Schedule September - April and Abbreviated Schedule May - August.**

Stop by the Lapidary Room #22 in No. Clubhouse for a schedule of classes. Annual dues are \$15. Jan. - Dec. includes instruction in one or all classes. An additional \$30 equipment fee will be charged in some classes. New members are always welcome!

## Lapidary (Cabbing Introduction)

Bob Caveglia

813-938-5665

KPCH

Tuesday

## Lapidary Room

9:00 AM      12:00 PM

A mandatory 4-week introductory course will begin on the first Tuesday of each month. Students must display adequate skill in equipment use and technique before attending open shop sessions. Limited to 4 students per session. Additional \$30 equipment fee.

## Creative Arts Continued....

### Lapidary (Cabbing—Open Shop)

	KPCH	Lapidary Room
Bob Caveglia	813-938-5665	Thursday 9:00 AM 12:00 PM

A Lapidist is an artist which forms stone, minerals, or gems into decorative items. The techniques are stone cutting, grinding, and polishing of stones to a particular shape to make “cabs” suitable for setting into jewelry pieces. Additional \$30 equipment use fee.

### Lapidary (Chain Maille)

	KPCH	Lapidary Room
Judi Caveglia	813-938-5665	Thursday 1:00 PM 3:00 PM

Instruction in the basics of opening and closing jump rings and mastery of basic weaves to produce jewelry such as bracelets and necklaces. Supplies needed: 2 pairs jewelry pliers, beading mat, jump rings.

### Lapidary (Faceting)

	KPCH	Lapidary Room
Vicky Langston	813-424-8904	Wednesday 1:00-3:00 pm
Dan Henderson	920-285-1338	

Learn the critical angles used in faceting gemstones. Completed projects can be put in settings for rings and pendants. Additional \$30 equipment fee will be charged in some classes. New members always welcome!.

### Lapidary (Gem Trees)

	KPCH	Lapidary Room
Richard Richmond	813-938-5395	Friday 10:00 AM 12:00 PM
Donna Rupert	330-770-1333	

Learn to make beautiful gemstone trees with a variety of construction methods and patterns. Supplies extra. New students may join on the first Friday of each month.

### Lapidary (Jewelry Making / Beading)

	KPCH	Lapidary Room
Shirley Westerhaus	813-938-4214	Wednesday 1:00 PM 3:00 PM
Linda Stone	319-481-7897	
Shirley Chandl	617-851-7316	

Learn to design jewelry using gemstones and seed beads using a variety of construction methods and patterns. Supplies extra.

### Lapidary (Kumihimo)

	KPCH	Lapidary Room
Judi Caveglia	813-938-5665	Tuesday 1:00 PM 3:00 PM
Evelyn Labadie	813-633-0244	

Create necklaces or bracelets using wire to weave a Viking chain. Kumihimo is an ancient Japanese art of bead weaving using a disk and various types of cords and beads. Kits to be supplied for an additional cost.

## Creative Arts Continued....

### Lapidary (Metal Arts)

	KPCH	Lapidary Room
Mary Lou DePalo	630-762-2138	Monday 1:00 PM 3:00 PM

Metalsmithing is the process of creating jewelry with metals such as copper, silver and brass. Skills of forming, shaping, sawing, drilling and soldering will be taught. There is an additional \$30 equipment fee and supplies are extra.

### Lapidary (Wire Wrapping)

	KPCH	Lapidary Room
Miriam Brown	813-634-7046	Monday 9:30 AM 11:30 AM

Students learn to make rings, bracelets, pendants, and earrings by using silver or gold wire by wrapping in various designs and weaves. Supplies extra.

### Machine Embroidery Group - Machine Stabilizer

	3rd Friday	9:00 AM 4:00 PM
Sandy Nunn	813-642-8961	KPCH Fiber Arts I

Learn how to use the embroider machinery to create embroidered art.

### Paper Dolls

	Fridays	10:00 AM 12:30 PM
Marilyn Flack	352-571-0538	KPCH Atrium
Pat Urban	727-455-3064	

Origami and quilling instructions offered for ornaments, greeting cards, jewelry and other creative items. Supplies will be provided for a nominal fee or bring your own. No dues.

### Paper Tole (3-D Paper Sculpture)

	Wednesday	9:30 AM 11:30 AM
Janice Kincaid	412-952-5689	2020 Centre Culinary

Paper Tole is the art of making 3D pictures from flat prints by using multiple copies of a print.

### Pottery Club (All Levels)

	RSVP for Class Schedules	
Darlene Glass	407-687-8964	KPCH Clay Studio

The pottery club provides a clay-filled and artistic outlet for students to learn, practice and further their skills. Instruction available in hand-building, wheel throwing and sculpting. No experience needed. Year Round dues \$45.00. Individual class fees will vary. RSVP for class schedules.

### Quilting

	Monday	9:00 AM 4:00 PM
Mary Grant	301-643-8266	KPCH Fiber Arts

Must know how to sew and have knowledge of your machine. We make a variety of sewing projects and quilt tops using various techniques. We do individual and group projects and share ideas. We make veterans and charity quilts too.

## Creative Arts Continued....

<b>Quilting 101</b>		Friday	9:00 AM	12:00 PM
Shirley Brink	813-634-2203	KPCH	Fiber Arts I	

New to quilting? This activity will teach you about the materials and techniques used while creating your first quilt. Teaching instructions / supplies \$35.00.

---

<b>Rubber Stampers</b>		Tuesday	9:00 AM	10:30 AM
Kathy Huffman	813-938-4278	KPSC	Game Room	

Create note cards, art, mix-media projects with stamps. Please be prepared to bring your supplies and share with group.

---

<b>Shell Art</b>		Monthly		
Karen King	419-260-1263	TBD	TBD	

We meet once a month for a workshop where we meet to create shell art projects and once a month we go to a beach to collect shells that we use in our workshops. For more information and the current schedule, contact Karen.

---

<b>Watercolor Inspirations Class</b>	Tuesday	9:30 AM	12:30 PM
Robin St. Onge	810-874-2798	KPCH	Art Room

Beginners to experienced. All levels of achievement. Explore different techniques and paint your own inspirations.

---

<b>Watercolor Painting Club</b>		KPCH	Art Room
Diane G. Simon	813-385-5569	Monday	9:00 AM 11:00 AM
		Thursday	1:00 PM 3:30 PM

Paint a new painting every two weeks, four week series for classes. Supplies available for purchase. Learn new skills and techniques. You don't have to draw to paint. Fun class for those who want to explore their creative side. All skill levels welcome.

---

<b>Wood Shop</b>		Monday - Friday	8:30 AM 11:30 AM
John Vogelsang	813-727-5901	KPCH	Woodshop

The wood working shop is open for woodworking basics to advanced hand and power tool techniques. Call for ordering and sale information.

---

# Dance

<b>Silver Shakers</b>	Thursday	10:30 AM	12:00 PM
"Jafali"	303-638-2784	KPCH	TBD

FUN, low-impact, low-cardio Middle Eastern dance. (Belly Dance) This dance form is perfect for those who want to improve their flexibility, movement, mental acuity and overall well-being through exercises and choreographed routines. Local performance opportunities will be offered when possible, but not required.

<b>Silver Shakers Beginners</b>	Thursday	9:30 AM	10:30 AM
"Jafali"	303-638-2784	KPCH	Banquet Rm

A new Beginning Belly Dance Class is starting on Thurs., Nov. 9th in the Studio. We will learn some basic moves and then incorporate them into a fun choreography. Open to KP and SCC residents. No charge. Wear comfy clothes, bring some socks and something to tie around your hips. Direct any questions to Jafali 303-636-2784.

<b>Country Western - Intermediate</b>	Friday	4:00 PM	6:00 PM
Bev Hitscherich	315-427-1175	KPCH	Studio

October-April— NOT LINE DANCING OR A **CLASS**. This is the intermediate practice for couples who have danced before or those who are rusty and want to brush up on the Waltz, Cha Cha, and specialty dances.

<b>Hawaiian Dance (Hula Honeys)</b>	Wednesday	11:00 AM	12:30 PM
Teresa Drake	970-215-1167	KPCH	Studio

Learn the beautiful dances of the islands. All levels of dance taught, beginners encouraged to attend.

<b>Tappers Beginner - Step by Step</b>	Tuesday	1:00 PM	1:30 PM
Gayle Hendrich	765-720-4911	KPCH	Studio

This is a beginner tap class. You will learn basic steps and simple routine called the Shim Sham. We practice steps and this routine to a wide variety of music and have a lot of fun. Buy tap shoes and improve your balance and your brain!

<b>Tappers Intermediate - Happy Tappers</b>	Tuesday	1:30 PM	3:00 PM
Gayle Hendrich	765-720-4911	KPCH	Studio

Happy Tappers is an intermediate level class for students who have had some beginning instruction. Tappers will have an opportunity to practice what they know and develop more speed. They will learn new steps and tap routines to a wide variety of music. Join this class to enjoy fun exercise for your mind, body and spirit! The Happy Tappers also volunteer to perform at assisted living and memory care centers in the area.

# Fitness

## Fitness Center Training

**Interested in learning the fitness equipment at the fitness centers? The fitness staff is here for you!**

Have you had a free orientation to the fitness equipment? Learn how to use the cardiovascular and / or weight machines.

Or would you rather have a personalized training with a certified trainer? Create and reach lifestyle goals made just for you! Please schedule an appointment by stopping by the front desk at 2020 Centre or by calling **813-387-3476**

### **Aerobics (Chair Dancing)**

Mon/Wed/Fri

9:15 AM 10:00 AM

KPCH

East West Social

Donna Kohler 716-491-1304

Sharon Moltz 609-412-6953

Exercise to the beat without leaving your seat.

---

### **The Taoist Tai Chi® Internal Art of Taijiquan (Beg.)**

Monday & Friday

9:30 AM 11:00 AM

Clifford Stockman 813-331-3824

Saturday

10:00 AM 11:30 AM

KPCH

Studio

No Fee. Learn the gentle mind art and balance techniques of Tai Chi.

---

### **Chair Tai Chi®**

Monday & Friday - Studio / Wednesday - Waterside

11:00 AM 12:00 PM

Irene Goetze 678-386-4702

Learn the gentle mind art and balance techniques of Tai Chi with the support of a chair.

---

# March 2024 Water Group Exercise Classes

Aqua Resistance 9:00 AM KPCH	Water Walking 9:00 AM KPCH	Double Noodle 9:00 AM KPCH	Aqua in Motion 9:00 AM KPCH	Deep Water 9:00 AM KPCH
Stretch & Flow 11:00 AM KPSC	Aqua Bata 10:00 AM KPSC	Wet Workout 10:00 AM KPCH	Aqua Bata 10:00 AM KPSC	Aquanautics 10:15 AM KPCH



## Class Descriptions:

**AQUA BATA:** full body workout using time intervals and various types of equipment.

**AQUA IN MOTION:** A moderate water workout using a loop band and then gentle exercises to improve strength, endurance, and flexibility.

**AQUANAUTICS:** A band and ball workout followed by a synchronized total body water workout.

**AQUA RESISTANCE:** Focuses on upper and lower body strength and endurance by using the water, wall, noodle and water weights as resistance.

**DEEP WATER:** An intense workout where feet are off the bottom of the pool in any depth of water that one is comfortable with.

**DOUBLE NOODLE:** Vigorous workout for the entire body using two noodles and no weights.

**STRETCH & FLOW WATER:** A thorough stretch from neck to toe.

**WATER WALKING:** Resistance bands for the upper body while moving using various types of walking and at different intensities. Also includes stretching.

**WET WORKOUT:** A foundational, no-equipment, total body workout of cardio, strength and mobility.

## Reminders About Cold Weather Policies For Water Classes:

If the current temperature of the air at the pool is **73** degrees or lower up to 15 minutes before the class is scheduled to start then the class may utilize the indoor pool. If the temperature is close to the designated temperature but the wind is above 10mph the class may utilize the indoor pool. **\*The instructor will be responsible for making the final judgement call for classes to move inside or remain outdoors.**

**\*\*All classes are held outdoors unless inclement weather.**

**\*SCHEDULE SUBJECT TO CHANGE.\***



## **Weather Procedures for Water Group Exercise Classes**

### **Cold Weather:**

If the current air temperature at the pool, according to the specified apps, is **73** degrees or lower up to 15 minutes before the class is scheduled to start then the class may utilize the indoor pool. \*If the air temperature is close to the designated temperature but the wind is above 10mph the class may utilize the indoor pool. The listed apps also designate wind speeds.

Apps to be used to determine air temperature and wind speed while at the pool deck and using “current location”:

>The Weather Channel                      >Weather Bug                      >Accuweather

### **Thunder and/or Lightning:**

>Any thunder heard, or lightning seen anywhere automatically closes the outdoor pool and pool deck.

>If lightning, according to the security-held lightening detector, comes within 6 miles, then the indoor pool and pool deck are also closed, and the indoor pool area is locked.

\*Security will close the pool and lock the appropriate gates for the designated duration.

### **Pool Temperature:**

If the temperature of the water in the outdoor pool feels considerably below normal the class may move to the indoor pool.

**\*The instructor will be responsible for making the final judgement call for classes to move inside or remain outdoors. Should a class utilize the indoor pool, it is important that class participants be courteous to other users of the pool.**

# March 2024 Land Group Exercise Schedule

Monday	Tuesday	Wednesday	Thursday	Friday
Total Body Express 8:00 AM & 9:00 AM	Zumba 9:30 AM Energy Studio	Total Body Express 9:00 AM	Zumba 9:30 AM Energy Studio	Total Body Express 9:00 AM Energy Studio
Total Body 10:00 AM Energy Studio	Flex & Flow 8:30 AM & 10:30 AM Energy Studio	Total Body 10:00 AM Energy Studio	Flex & Flow 8:30 AM & 10:30 AM Energy Studio	Total Body 10:00 AM Energy Studio
Beginning Yoga 8:45 AM & 10:00 AM <i>Balance Studio</i>	Sit & Get Fit 11:30 AM & 12:30 PM Energy Studio	Beginning Yoga 8:45 AM & 10:00 AM <i>Balance Studio</i>	Pilates 9:30 AM & 10:30 AM <i>Balance Studio</i>	Yoga Flow 8:45 AM & 10:00 AM <i>Balance Studio</i>
Fit Mix 11:30 AM Energy Studio	Improver Line Dance 2:00 PM Energy Studio	Strong Body 11:30 AM Energy Studio	Sit & Get Fit 11:30 AM & 12:30 PM Energy Studio	First Steppers Line Dance 2:00 PM
Chair Yoga 1:00 PM Energy Studio	Intermediate Line Dance 3:00 PM Energy Studio	Chair Yoga 1:00 PM Energy Studio	Improver Line Dance 2:00 PM Energy Studio	<div> <div>*Schedule is subject to change.*</div> </div>

Did you know we also offer additional classes on our Pop Up schedule? See posted signs in the 2020 Centre for the monthly Land Pop Up



## How to Sign Up For Classes Online Using SignUp Genuis

- > Go to website [www.kingspointuncitycenter.com](http://www.kingspointuncitycenter.com).
  - > Click on the "Fitness" tab near the top of the page.
  - > Click "Fitness Class SignUp".
  - > Across the top of the page, click the tab representing the day of the class you wish to sign up for.
  - > Scroll down until you see the class you wish to sign up for and click the green "Sign Up" box.
  - > Click "Save & Continue".
  - > Fill in all boxes of your contact information then click "Sign Up Now"
- \*Reminder, class sign ups close the day of at 5:00AM. You can sign up for a class up to 5 days in advance.

## **Class Descriptions**

**BEGINNING YOGA:** this class is for those new to yoga or those wanting to fine tune their practice. We will use the breath and body awareness to build strength and increase flexibility.

**CHAIR YOGA:** Class designed to include breath work, strength, flexibility and balance but does not involve getting up and down from the floor. Great for ALL fitness levels!

**FIRST STEPPERS LINE DANCE:** No knowledge of line dancing or steps names.

**FIT MIX:** A fast-paced strength class incorporating a mix of standing and floor exercises using a variety of weights and resistance bands.

**FLEX & FLOW:** A combination of tai chi, yoga & Pilates style movements set to a variety of music to work your core, challenge your range of motion, strength and balance without floor work.

**IMPROVER LINE DANCE:** Student knows basic line dance steps and will learn additional steps. Constant instruction.

**INTERMEDIATE LINE DANCE:** Some knowledge of line dance steps. Continuous instruction of more difficult steps.

**PILATES:** Pilates is a low impact mat class that focuses on toning and strengthening the abdominals, back, and legs. Suitable for all levels, does involve floorwork.

**SIT & GET FIT:** Train the entire body using various pieces of equipment while remaining seated. Great class for beginners and those with ailments!

**STRONG BODY:** Strength-based class using barbells, dumbbells, and body weight exercises designed to increase and maintain muscle endurance and strength.

**TOTAL BODY:** A full body strengthening class that utilizes hand weights and other equipment.

**TOTAL BODY EXPRESS:** Full body strength workout without floor work.

**YOGA FLOW:** Suitable for all levels that have some previous yoga experience. Low impact, relaxing, mindful yoga emphasizing flexibility and light strength. Breathing and stress management techniques incorporated.

**ZUMBA:** A Latin inspired cardio class filled with fun dance moves that guarantee a good time and a great workout.

### **\*Mats will not be provided for any class.\***

**Reminder:** A more extensive group exercise schedule of classes is available to view 24/7 online at [www.kingspointuncitycenter.com](http://www.kingspointuncitycenter.com)>Fitness>At Home Fitness Videos

You can also watch pre-recorded versions of your favorite classes played **daily** in your home on Spectrum Channel **732**.

7:00AM	Pilates	11:00AM	Zumba
8:00AM	Total Body Express	12:00PM	Flex & Flow
9:00AM	Chair Yoga	1:00PM	Sit & Get Fit

## Gaming

<b>Bingo</b>	KPCH Card Room	Thursday	11:00 AM	3:00 PM
Naomi Vega	813-938-1707	Sunday	1:00 PM	5:00 PM

Bingo is a game of chance played with randomly drawn numbers which players match against pre-printed cards. Pay for what you play. Sponsored by Cambridge B Association. **Thursdays, doors open at 11:30 am. Games starts at 12 pm. Sunday, doors open at 1:00 pm. Game starts at 2 pm.** Papers sold in packets of Single (\$9) Double (\$17) Triple (\$25) Please bring your own placemats and daubers.

<b>Bingo</b>		Saturday	4:30 PM	8:45PM
Edna Lozosky	813-633-4352	KPCH	Card Room	

Pay for what you play. Sponsored by Lancaster III Association. **Doors open at 4:30 pm. Game starts at 5:45 pm.**

## Indoor Sports

<b>Bowling, (Mixed League)</b>		Wednesday	1:00 PM	
Pete DeRupo	813-337-8238	KPCH	The Alley, Riverview	

Off Property at The Alley in Riverview. \$13.00 per week

<b>Table Tennis Club</b>		Mon. and Wed.	5:00 PM	8:00PM
Dave Reed	734-674-0736			

2020 Centre                      Energy Studio

Annual club dues: \$10 per person. All are welcome to come and play; no experience necessary. Membership required after three trial sessions. Appropriate footwear must be worn. No Flip-flops or sandals. Check us out on the web at <https://sites.google.com/site/kingspointtabletennis/home>

## Music/Theater

<b>Chorus, Kings Point (Mixed Group)</b>		Monday	12:30 PM	2:30 PM
Kathleen Brady	610-586-7433	KPCH	East Social Rooms	

Spring season begins January. 9, 2023. Soprano, alto, tenor and bass. Rehearsals on Mondays, from 12:30 to 2:30 pm. January to April for the spring concert. (September to December for the holiday concert). Dues are \$20 per season. If you can carry a tune and love to sing, please join us. Email: kbrady610@gmail.com.

<b>Pelican Players</b>		Special Events		
Shirley Walker, Membership	813-217-1602	KPCH	TBD	

Annual club dues. Pelican Players has something for everyone. We welcome anyone who has an interest in theater, whether performing on stage or working behind the scenes. If you want to show off your singing voice, you can be a part of our Cabaret Singers, or if you don't want to memorize lines, participate in our Readers Theater. For more information on all the above and more, check out our website at [www.pelicanplayersccc.org](http://www.pelicanplayersccc.org).

<b>Ukulele Club</b>		Tuesday	10:00 AM	11:00 AM
Marion Orlofsky	813-633-6940	KPCH	Atrium	

All those interested in playing the Ukulele, come join us for 90 minutes of jamming fun. Beginners are welcome, lessons provided.

## Outdoor Sports

<b>Kings Point Archery Club</b>	3rd Wednesday	4:30 PM	5:45 PM
Steve Nicholson 610-216-9153   Bill Humes 813-633-9361   KPCH		TBD	
The archery range at Kings Point is open 7 days a week for all club members. The range is located behind the garden club. For more information go to <a href="https://sites.google.com/site/kingspointarcheryclub">https://sites.google.com/site/kingspointarcheryclub</a>			

<b>Bocce Ball Group</b>	KPCH	Bocce Court	
Tom Barba                      813-633-0264	Friday	9:00 AM	11:00 AM
Bill Poulin                      603-520-3918	Saturday	10:00 AM	12:00 PM
Join us for some Bocce Ball fun on the Bocce Ball court every Friday and Saturday.			

<b>Kings Point Cornhole Club</b>	Mon., Weds., Fri.		
Jim Fialkowski at 262-237-4266   Penny Hart at 423-453-9769   KPCH		Across to Lawn Bowling Crt	

Join us today! We play at the North Court Complex adjacent to the Lawn Bowling Courts on Mon., Wed. & Fri. Summer hours-May 1-Sept. 30, 9 am-12 pm, start time 9:45 am/Winter hours-Oct 1-April 30 2 pm-6pm, start time 3:45 pm. Visit [www.kpcornhole.com](http://www.kpcornhole.com) for more info or call Penny 423-453-9769 or Jim at 262-237-4266.

<b>Kings Point Pickleball</b>	Monday-Sunday	Dawn	Dusk
Suzan Hill 606-831-2789   Karin Coons 914-213-7592   KPCH		Pickleball Court	
Welcome to Pickleball! We have groups that represent all levels of playing abilities and meet at different times. We also offer occasional clinics, ladders, competitive play and social activities. You need to be a member in order to use our Pickleball equipment or participate in organized play times/groups. To sign up for a free clinic or to find out other information about the club, please email: <a href="mailto:suzanhill1865@yahoo.com">suzanhill1865@yahoo.com</a> .			

<b>Lawn Bowling</b>	Mon/Wed/Fri	9:15 AM	11:30 AM
Dave White                      813-538-8821	Tues./Thurs./Sat	1:30 PM	4:15 PM
	KPCH	Lawn Bowling Greens	
October—April   Annual membership fee due by February 1st. Lessons are required at no charge. For information about the club, dates and times contact the president. Annual elections in December			

<b>Lawn Bowling (Summer)</b>	Monday - Saturday	8:45 AM	11:00 AM
Dave White                      813-538-8821	KPCH	Lawn Bowling Greens	
May—September   Annual membership fee due by February 1st. Lessons are required at no charge. For information about the club, dates and contact the president. Annual elections in December.			

## Outdoor Sports Continued...

### Shuffleboard Group (Afternoon)

Maureen and Ed Bertucci 813-634-2787

Tuesday

KPCH

4:15 PM 6:00 PM

Shuffleboard Courts

October—April Shuffleboard is a game in which players use cues to push weighted discs, sending them gliding down a narrow and elongated court with the purpose of having them come to rest within a marking score area. Annual club dues, per person.

### Shuffleboard Club (Playing)

Jim Forgione 813-323-7493

Tuesday & Friday

KPCH

9:00 AM 11:00 AM

Shuffleboard Courts

Shuffleboard is a game in which players use cues to push weighted discs, sending them gliding down a narrow and elongated court with the purpose of having them come to rest within a marking score area. Annual club dues, per person.

### Softball Club (Kings Point)

Tom Mackar 440-376-6573

Tuesday & Friday

Don Senk Softball Field

Year round participation opportunities are available for players, spouses, spectators, umpires, scorekeepers, managers, refreshment workers, etc. Visit [sccsoftball.squadfusion.com/welcome](http://sccsoftball.squadfusion.com/welcome) for additional information.

### Tennis Club

Vincent Petaccio 813-816-6487

Monday - Saturday

KPCH

10:00 AM 12:00 PM

Tennis Courts

If you are interested in playing tennis, Kings Point Tennis Club offers a great opportunity to get out on the courts. Whether you're just learning to play or you've been playing for years, there is a place for you in our club. Social tennis play with all club members are held on Tuesday, Thursday, and Saturday in the AM. The courts are also available on Monday, Wednesday, and Friday, if you would like to play with a specialized group. We strive to create a fun environment where people can safely participate in social and physical activities through tennis. We host occasional clinics and organized tournaments. Club dues are \$10/year.

### Volleyball (Playing)

Chip Hoffmann 203-994-2123

Mon./Wed./Fri.

KPSC

9:00 AM 11:00 AM

Court 4 South Club

November-May Join us on the volleyball court for good exercise, friendship and fun.

## Parlor Games

### Bunco

Naomi Vega 813-938-1707

Monday

KPCH

12:00 PM 4:00 PM

Ripple Rm

Bunco is a social dice game involving 100% luck! Meet new friends and roll the dice with us!

### Kings Point Chess Group

Gus Egert 813-419-4626

Wednesday

KPCH

1:00 PM 4:00 PM

Atrium Rm

Mark Schonfeld 914-589-8051

All levels of play.

<b>Dominoes (Mexican Train)</b>		Wednesday	12:30 PM	4:00 PM
Claudette Bernstein	813-938-3182	KPCH	Fiber Arts I	
Please bring your game.				
<b>Mah Jongg Club</b>		Friday	12:30 PM	4:00 PM
Barbara Sarner	813-922-4546 / 631-741-2177	KPCH	Card Room	
Enjoy the game of Mah Jongg w/ friends. \$6 annual dues. Free lessons 3 times a year w/ club membership.				
<b>Rummikub</b>		Monday	1:00 PM	3:00 PM
Elyse Dionisio	631-748-4222	KPCH	South Social Room	
All welcome. Easy to learn.				
<b>Scrabble</b>		Monday	10:00 AM	12:00 PM
Sandra McCullough	443-326-8606	KPCH	Atrium	
Join residents in a board game using lettered tiles to create words in a crossword fashion. Socialize and learn new words with a game of scrabble.				

## Services

<b>AARP Driver Safety Program</b>		Varies	Varies	Varies
Registration—Marcus Vinson	813-862-8397	KPCH		
Defensive driving classes. Students must pre-register, and will pay the instructor at the class. Cost is for instructions and hand outs. RSVP Class Limit 25. Dates Vary. Please call for dates and to register.				
<b>COA Monthly Meeting</b>		1st Wednesday	2:00 PM	4:00 PM
813-633-1710		KPCH	Banquet	
September- May Annual elections held in February. COA hours: June & July are Mon./Wed./Fri. 9 a.m. to 12 p.m. Closed the month of August. September through May are Mon.-Fri. 9 a.m. to 12 p.m.				
<b>Federation Board Meeting</b>		1st Friday	9:30 AM	11:30 AM
Jim Grundy, President		KPCH	Card Room	
An opportunity for residents to express their views and concerns during an Open Forum before Directors vote on specific issues. *UNIT OWNERS WELCOME*				
<b>Federation Membership Meeting</b>		3rd Friday	9:30 AM	12:00 PM
Jim Grundy, President		KPCH	Veterans Theater	
September-May Representative body meets to discuss and vote on current issues. Unit Owners are invited to attend and may speak at the beginning of the meeting during an open forum.				

## Services Continued....

<b>Master Association Board Meeting</b>	2nd Wednesday	9:30 am - 11:00 am
Jim Haggerty, President 813-812-7559	KPCH	Card Room

The Master Association provides supervision, management, and determination as to the care and maintenance of roads, traffic control, landscaping within the roadway, drainage systems, and irrigation systems located throughout Kings Point.

---

<b>SCC Emergency Squad 24/7</b>	<b>Non-Emergency</b>	<b>813-633-1411</b>	<b>Emergency</b>	<b>813-634-3800</b>
Sun City Center Emergency Squad was started in 1964 with 14 volunteers. Today over 200 volunteers are ready to assist you 24 hours a day, 365 days a year. Emergency transportation available 24 hours.				

---

<b>Jen's Open Air Market</b>	1st Tuesday of the Month Oct—April	10:00 AM—2:00 PM
------------------------------	------------------------------------	------------------

KPCH front lawn near the Pickleball courts under the big oak trees. Browse over 30 vendors ranging from fresh produce to arts & crafts. Food Trucks will also be available. Days and times subject to change with weather and events.

## Clubs and Organizations

<b>Amateur Radio Club</b>	2nd Monday	1:00 PM	4:30 PM
For information email	ecom@kparc.org	KPCH	Meeting Room

The Sun City Center Amateur Radio Club is recognized by the Florida Emergency Operations Center in Tallahassee. The club promotes the hobby and provides license training. SCC Amateur Radio club provides emergency communications to the Sun City Center community in times of crisis and support organizations that require communications for projects. Radios may be purchased Thurs. or Sat. mornings 9-11 AM

---

<b>Apple Club</b>	Gary Brian	502-544-6057	2nd Wednesday	1:00 PM - 3:00 PM
-------------------	------------	--------------	---------------	-------------------

Come join us in our journey of the exploration of all things Apple. Meetings are the second Wednesday of each month in the Veteran's Theater North Clubhouse from 12 pm-2 pm. ( No meetings in the months of June, July or August) Annual dues are \$25 per household, \$15 individual, Kings Point residents only. Help sessions are held every Monday and Thursday from 9am-11am at the 2020 club in the culinary room.

<b>Baby Boomers, Kings Point</b>	Special Events	
<a href="http://www.kpbabyboomers.org">www.kpbabyboomers.org</a>	KPCH & KPSC	TBD

Members are KP residents who are "Old enough to have done it all and young enough to do it again." We are an active club that has a variety of social events. Applicants for membership are available on the club website

Canadian Club, Kings Point	Special Events
	KPCH
	TBD

A social club with a few events planned to bring Canadians together from December to April (e.g., pot luck, Meet and mingle, golf tournament, dinner/dance). Please contact kpcacub@gmail.com for more Information ro to provide your email address to the mailing list.



## Clubs and Organizations Continued....

### **Come Dance With Us**

Ken Burger                      513-582-8449

Monthly

5:00 PM      9:30 PM

KPCH

Veteran's Theatre

Rosemary Burger              513-258-8238

We are a social dance club of couples and singles who enjoy dancing to waltz, rumba, tango, cha-cha, jitterbug, polka, swing and line dance. Our music is provided by performers who sing to recorded music.

---

### **Discussion Group**

Chris Leavitt                      585-334-6393

Tuesday

10:30 AM      12:00 PM

KPCH

West Social Rm

We talk about any topic you can think of: Including religion, current events, psychology, politics, etc. We want opinionated people who are willing to speak up. chrleavitt@aol.com.

---

### **Dog Lover's Club**

Special Events

Lynne Weise                      410-913-1285

TBD

The Dog Lovers Club has established an off-leash dog park in KP for dog owners and their best friends. Call Sally Reisman at 813-812-7303 or Judy Johnson at 813-633-0233 for information.

---

### **Economic Discussion Group**

2nd & 4th Wed

3:30 PM      5:00 PM

Dan Cannistra                      941-730-9093

KPCH

Atrium

Alternating class topics on financial education; today's volatile markets and protection of your assets. Residents receive handouts.

---

### **Feline Folks**

1st Thursday

3:30 PM      5:30 PM

Sheila Thurston    813-938-4840

2020 Centre

Culinary Room

Meetings held 1st Thursday of each month at 3:30pm with our Meow Mixer featuring light snacks and beverages at 4:30pm.

---

### **Garden Club**

2nd Thursday

2:30 PM      3:30 PM

Chris Robinson                      612-599-9747

KPCH

Ripple Room

October-April    The purpose of The Garden Club is to stimulate the knowledge and love of gardening within Kings Point. Annual club dues, per membership. Club Elections December.

---

### **Healthy Lifestyles MeetUp**

Various Locations

Stephen Cooper                      (248) 890-1890

Email: healthymeetup@aol.com

Enjoy Interesting speakers, fun activities, discussions and support for those interesting in longer, healthier and more disease-free lives.    [www.healthymeetup.org](http://www.healthymeetup.org)

---

## Clubs and Organizations Continued....

### Heartland Club Social Group

#### Special Events

John or Bev Wohlrab      309-525-2871      KPCH      TBD

A social club serving as a welcome mat to all SCC residents and snowbirds, especially with ties to Minnesota, Illinois, Indiana, Iowa, Missouri, Kansas, and Nebraska. Call above or email [jbwohlrab@gmail.com](mailto:jbwohlrab@gmail.com) for info.

### Italian Club

Frank Oleskewicz      813-300-4010      Special Events

Brenda Raysbrook      813-447-0388      KPCH      TBD

October-May Watch for announcements for room, date and time for club meetings. Annual club dues \$10 per person. Annual elections in March.

### Kings Point Dance Club

#### Special Events

7:00 PM      9:00 PM

Eileen Reig      813-296-4038      KPCH      Veterans Theater

Once a month (October thru April) gather with your friends for social dancing and live entertainment. Dance to fox trots, swing, polka, cha cha and waltz music. Annual dues \$25 per person.

### Kings Point Florida Friendly Plant Club

#### Meets 4th Thursday

4:30 PM      6:00 PM

Cat Drinkard      Susan Heyer      [kpffplantclub@gmail.com](mailto:kpffplantclub@gmail.com)      KP2020 Center Culinary Rm

FL. Native and Florida-Friendly plants! We enjoy learning and helping each other improve our flower beds with the **right plant in the right place**. Our goal is to create beautiful flower beds that thrive, have low water and maintenance needs and attract wildlife! We are a happy group of folks—please feel free to stop in at our meetings or send us an email. We have a lot of FREE resources to share.

### Michigan Club

#### Special Events

Marilyn Elliott-Enge      636-795-4823      KPCH      TBD

October—May Join us for fun parties; SNO-BALL GALA, Pizza & Beer, St Patty's Day, Kentucky Derby, holiday pot luck and more! Club dues per year. Activities are added to the Pointer and the wheel/channel 733.

### Model Railroad Club

#### Mon, Tue, Thurs & Fri

1:00 PM      3:00 PM

Chet Rindfuss      206-979-1123      KPCH      Model Railroad Room

The Model Railroad Club builds, operates, and promotes model railroading for the benefit and enjoyment of the club members. All residents welcomed. Annual Dues, Initiation fee of \$30. Optional \$5 for keys.

### New Englander's Club

#### Special Events

Tom Pellerin      813-534-9435      KPCH      Veterans Theater

October—April Social group meets for dinner and dancing. Annual club dues. Annual election held in April. Please email [newenglandersclub@gmail.com](mailto:newenglandersclub@gmail.com) for more information.

## Clubs and Organizations Continued....

<b>New York Empire State Club</b>		1st Tuesday	5:00 PM      8:30 PM
Susan Gill	954-483-9866	KPCH	Veterans Theater
Frank & Joan Gatto	813-633-8942		

Everyone is welcome to join this social group for dinners and dancing. During June, July and August the group meets at local restaurants. The membership cycle is from December to December. After May new members will need to wait until December to join. Dues are \$10.00 per year.

<b>Photography Club (Kings Point)</b>		2nd Tuesday	10:00 AM
Walt Neuman	727-871-9295	KPCH	Waterside Rm

September-May Club offers a formal organization to promote, educate and achieve personal skills and knowledge as photographers. For more info., call Walt Neuman or email: [perroquet024@gmail.com](mailto:perroquet024@gmail.com).

<b>Rockin' Thru the Years</b>		Sundays	6:00 PM
Sandi Zoldi	813-298-9632	KPCH	Veterans Theater

"Join Us For a Rockin' Good Time!" Live bands provide music from the '50's to the '80's as well as more current music from today for our dancing and listening pleasure. BYOB and Snacks. Tickets are \$10 per person per dance. Email [rockinthrutheyears@gmail.com](mailto:rockinthrutheyears@gmail.com) Sunday Dances: TBA

<b>Sportsman's Club</b>		3rd Wednesday	3:00 PM      4:30 PM
John Barry	813-633-5910	KPCH	Veterans Theater

The Sportsman's Club is dedicated to promoting shooting sports including, pistol, rifle, sporting clays, fishing, hunting, and wildlife conservation. Social events are organized throughout the year. Monthly meetings include: guest speakers, cash door prizes and refreshments. For more information, check out our website at: [kingspointssportsmansclub.com](http://kingspointssportsmansclub.com). Annual dues \$8.00.

<b>T.O.P.S. (Take Off Pounds Sensibly) #788</b>		Tuesday	8:00 AM      10:00 AM
Roberta Rowe	813-215-7127	KPCH	West Social Rm.

Weigh in begins at 8:00 a.m. and meeting starts at 8:30 a.m. T.O.P.S. is a support group for people who want to lose weight. Try the first meeting for free!

<b>T.O.P.S. (Take Off Pounds Sensibly) #845</b>		Thursday	8:15 AM      9:45 AM
Charlene Svenson	978-930-0878	KPSC	Jubilee I

Weigh in starts 8:15 am and the meeting starts 8:45 am The weekly programs and incentives promote our "weigh" of life as good health and well being are supported in a friendly group setting. National annual dues of \$37 provide resources including the TOPS monthly magazine. Chapter annual dues \$5.00 per month.

<b>Wisconsin Social Grp</b>		Special Events	KPCH
Linda Zizzo	262-441-0006	Bev Hetzel, Membership	309-236-2900

Meet up with fellow Wisconsinites at our three socials per year - Nov. Jan. & March. Call us today to join the fun! Announcements of meeting time and location on the website and the wheel. Check us out on our website at [www.2ezwebdesign.com/WisClub](http://www.2ezwebdesign.com/WisClub)

---

## Sun City Residents—Reciprocal Club Pass Procedures

### I. YEARLY June 30<sup>th</sup> RENEWAL

- A. Club (president or designated leader) will email the name, address, phone number of
- B. reciprocal non-resident members to the business office by May 1st.
- C. Vesta staff will print new badges for reciprocal non-residents and will call / email when ready for pick up.
- D. Club (president or designated leader) will distribute new badges

### II. LIST MAINTENANCE

- A. New Non-Resident Members (Reciprocal privileges are for Sun City Residents)
  - a. Club representative will send name, address, phone to Vesta for badge printing as they come in
  - b. Vesta will print new badges and give to club representative to distribute
- B. Members Leave
  - a. Club representative will ask for badges to be returned
  - b. Club representative will send badge / name to Vesta staff
  - c. Vesta will take off role

### III. SPECIAL EVENTS

- A. Ticketed Events – the ticket is the pass; Tickets should include: Event Name, Date, Time and Location
- B. Non-ticket Events – non-resident names without passes or outside of Sun City need to be submitted to gate via email to: KPSCCvisitor@vestapropertyservices.com 48 hours before the event. The gate will need the name, address and phone number of the guest along with the club leader information. If a person is not on the list, the contact of the club will call the front gate to let in the guest.

### IV. NON-RESIDENTS OUTSIDE SUN CITY CENTER

- A. Non-residents with addresses outside of Kings Point / Sun City Center, need to be submitted to the Front Gate for each event.
- B. Name of Event, Date of Event, Club Leader Contact Information  
Guest Name, Address, Phone for each person entering

### Contact Information

Front Gate – 634-2063 KPSCCvisitor@vestapropertyservices.com

Security Questions - Peter Doxsee, Chief of Security 813-387-3461

Business Office - 813-387-3439 or Nanette Leggett 813-387-3481 NLeggett@vestapropertyservices.com